

Bavaria 34C – 2008, EU VAT NOT Paid status

A Perfect Blend of Performance and Comfort

Well updated and maintained with new standing rigging and guard rails December 2022. Under water treatment, epoxy treatment and antifoul August 2023 as well as full engine service. New and extended battery bank 2023.

Set sail on the high seas with confidence in the 2008 Bavaria 34, an exceptional cruising yacht that combines quality craftsmanship, ease of handling, and comfortable living spaces. Whether you're a seasoned sailor or new to the boating world, this vessel is the perfect companion for your next adventure. A very comfortable UK registered yacht in very good condition and all you need for family coastal cruising and live-aboard!

The Bavaria 34 Cruiser is a very popular model, designed by J & J Design for Bavaria. This version is the attractive 2-cabin version with two large double cabins

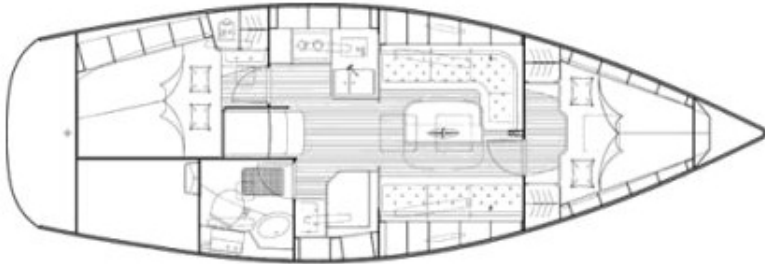

FACTS

YEAR & SIZE

Model year 2008
Length: 10,71 m
Width/Beam: 3,60 m
Draft: 1,90 m
Mast height (Bridge Clearance) approx 15 m

ENGINE

Volvo Penta D1-20 (approx 1900 hours)
Power: 14kW/18 HP
Fixed 3-blade prop
Fuel tank: 150 liter

SAIL

Mainsail – probably original but in good condition
Headsail/Genoa Original in good condition
Sprayhood 2021

RIG

Fractional Sloop
Standing Deck Stepped Mast: Selden In Mast Furling
Boom and Kick: Selden
Furler: Selden Furlex 200 S
Winches: 2 * Lewmar 30 + 2 * Lewmar 40





and it is even possible to sleep 2 in the Salon. The feeling when you are in the boat is the one you otherwise only have in much larger yachts, but at the same time good performance. Having the 2-cabin version also gives you a spacious bathroom/head with shower area and provide you with a huge storage area in the cockpit locker providing space for ropes and lines, extra jerrycans, tank for outboard and deflated dinghy or other water toys.

Special for this Bavaria model is also the practical fold-down swim platform in the aft, also super convenient in marina or when arriving by dinghy to the boat.

With this Bavaria model you simply get a perfectly sized sailboat with a great sense of style and comfort. You may both do live aboard and go cruising or simply enjoy sailing and stayovers with room for family and friends. She is a great sailor and very easy to handle with all control from cockpit. Even sailing single-handed is easy in a boat like this designed for comfort with in-mast



DETAILED SPECS

GENERALLY

- Model year 2008
- HIN: DE-BAVP34B7G708
- Name: S/Y ARROCH
- Length: 10,71 m
- Width/Beam: 3,60 m
- Draft: 1,90 m
- Displacement: 7950 kg (empty)
- Mast height (Bridge Clearance) appr 15 m
- Layout with two cabins (aft cabin and forward Cabin) and a total of 6 berths incl 2 in salon.
- One Head/Bathroom/Toilet

ENGINE

- Volvo Penta D1-20 – (appr 1900 hours)
- Engine number: 5102347309P
- Power: 14kW/18 HP
- Saildrive S130 #51300733698
- Fixed 3-blade prop
- Fuel tank: 150 liter

NAVIGATION & ELECTRONICS

- Plotter: Raymarine C70
- VHF: ICOM IC-M505 + extra handheld ICOM IC-M25
- Radar (not working – probably wire break in mast)
- Wind/Dept/Log: ST60+ (several)
- Stereo and speakers inside and in cockpit
- Radar Reflector on mast

RIG & WINCHES

- Fractional Sloop
- Standing Deck Stepped Mast: Selden In Mast Furling
- Boom and Kick: Selden
- Furler: Selden Furlex 200 S
- Winches: 2 * Lewmar 30 + 2 * Lewmar 40
- All sail handling available in Cockpit
- New Standing Rigging, and new Running Rigging 2022

SAILS & CANVAS

- Mainsail – probably original but in good condition
- Headsail/Genoa Original in good condition
- Sprayhood 2021
- New Cockpit Cover/Tent installed 2022

BATTERIES AND CHARGING

- Shore power connection Current: 240V system panel with switches for sockets, battery charger
- 12V DC system
- Battery 1: Start Battery 100 ah
- Battery 2+3: 2*190 Ah for service bank (2023)
- Charger: SBC 220v/12v 45A Charger
- Shore power 220v (with 220 volt outlet distributed in boat)
- Multiple USB outlets
- Lightning: LED
- Navigation Lights: LED

WATER, HEATING AND SANITATION

- 1x freshwater tanks – total 210 l
- Water heater that heats both via shore power and engine.
- Jabsco Toilet/head with manual flush
- 80 liter plastic Holding tank
- Pressure water to mixer tap in Galley and Head and shower on swim platform
- Double SS sinks in Galley
- Gas installation w manual shut-off valve in Galley
- Gas alarm in Galley



furling main and roller furling headsail. This yacht even has Bow Thruster for easy single hand navigation in marinas.

Coming down the stairs from Cockpit you have Kitchen/ Galley on portside with a large refrigerator, a double sink, a 2-burner stove, and oven. On Starboard side you have the Navigation table and all electric panels and instruments for navigation.

The salon has a large L-shaped sofa on portside with a large table and a sofa for two to three people on the other side. Around the table you easy sit 6 people. Lots of storage space both behind and below sofa as well as some storage areas in the floor.

Master cabin is in the forward part of the boat with a nice large comfortable double bed and good size closets and cupboards.

In the aft she has a extra large double bed cabin, also with nice storage closets and access to the saildrive and back side of engine.

All lights in and out including navigation light is LED. Teak only in cockpit leaving deck area maintenance free.

Anchor is a 15 kg CQR and powerful Lofrans Windlass with galvanized chain.

All mooring lines, fenders, some spare parts, full set of kitchenware etc comes with the boat.

The boat was originally purchased by first owner in UK

DETAILED SPECS

- 2-burner gas stove and gas oven in Galley
- Microwave oven (for shore power)
- Top loaded Refrigerator in Galley
- Heater: Airtronic 4kW
- Automatic bilge pump
- Manual bilge pump in cockpit

MISCELLANEOUS

- Misc Safety equipment , Several Fire extinguishers, Life lines
- Misc mooring lines, fenders, tools and spares
- Electric Cooker element for 240volt (new and practical when in marina)
- Survey done September 2022. Report available. 2019
- Dinghy and outboard not included in price but can be separately added if required

DISCLAIMER

Looma4Yachts offers the details of this vessel in good faith, but cannot guarantee or warrant the accuracy of this information nor guarantee the condition of the vessel. A buyer must instruct his agents, or his surveyors, to instigate the details the buyer wishes to validate.



and sailed in that area the first two years. In 2010 the previous owner bought her and sailed mainly summer-time along the coast of Great Britain. Current owner bought her and sailed to English Channel to France and across the Bay of Biscay to Spain and the beautiful Galicia on the Atlantic coast to Portugal. She is now on a permanent berth Lagos, Portugal and have here mainly sailed daytrips on the beautiful coast of Algarve. She has proven her strength in both longer overnight sailtrips on open water and also coastal waters for day and weekend trips. The Bavaria 34 been proven the perfect and cost optimal size for both longer trips and for day/vacation use. The current owner now wish to upgrade to larger vessel for Blue Water Cruising and live aboard and therefore let her on to new owners. The contract for the berth in Marina de Lagos can follow with the boat if required.

The boat is today registered in UK, and new owner therefore have pay VAT/IVA in Portugal if new owner want to register boat in EU.

The current owner has maintained her well and during the last years have had the local very well praised Yacht Service company "Slick Hull" to maintain and service her both outside, hull, antifoul, and engine. Last haul out was August 2023.

The last owners invested a lot to keep her up to date.

Some of the bigger investments being:

2019: Saildrive Seal and Prop replaced

2019: HMI (engine control panel) (eng hours before change 1265h)

2021: New Spray-hood installed

2022: New Cockpit Cover installed

2022: New Heat Exchanger

2022 (Dec): New Standing Rigging, and new Running Rigging

2023: Keel and underwater hull, sanded, epoxy treated and antifouled

2023: All anodes changed

2023: Several Hoses, Seacocks replaced

2023: 2*190Ah service batteries installed (total 380 Ah).

2023: Engine and gearbox service

